



Hoover's quick & snappy start up guide.

60 cm Touch Control
Ceramic Cooktop



Model #: HV-C60CC
Version #: V1.0
After Sales Support 1300 886 649

Let's get your cooktop up and running!

Welcome to your new Hoover cooktop! We hope that this product brings you many years of enjoyment.

IMPORTANT! This cooktop must be professionally installed to an appropriately earthed wiring system by a licensed electrician, following the instructions in the supplied instruction manual.

Please ensure you make the manual available to the electrician. Do not try to install the cooktop yourself! Doing so will expose you to danger and could invalidate any warranty or liability claims.

Consult the full instruction manual for comprehensive installation, usage and cleaning instructions and important safety advice. This guide only contains basic usage instructions.

First Use

- Switch on one cooking zone at a time and let it heat up for 5 minutes at the maximum setting.
- Place a saucepan filled half full with cold water on each zone as you burn it off, one zone at a time.

NOTE: Any odour or smoke on first use can be disregarded safely. It will disappear with repeated use. Ensure good ventilation.

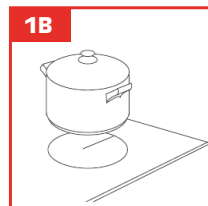
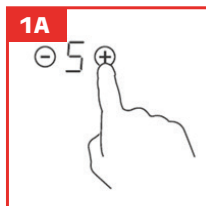

Control Panel

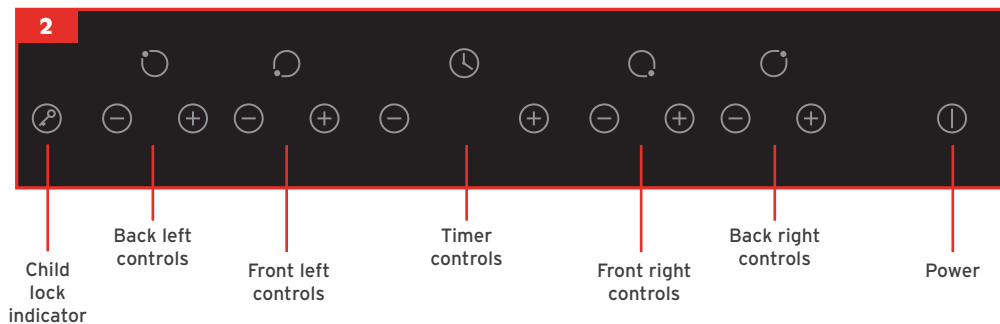

Using the Cooktop

- Touch the power button to switch on the cooktop. All indicators will show [-].
- Place a pan on the cooking zone you want to use. The pan and cooking zone diameters should match. Make sure the bottom of the pan and the surface of the cooking zone are clean and dry.
- Select a heat setting by touching the [-] or [+] control for the cooking zone you want to use. You must do this within one minute, otherwise the cooktop will automatically switch off.
- When you have finished cooking, turn the cooking zone off by touching the [-] control until [0] is shown, or by touching the [-] and [+] controls at the same time.
- Turn the whole cooktop off by touching the power button.

NOTE: Residual heat warning

- After a cooking zone is switched off, the residual heat indicator [H] indicates that the temperature of the zone is still high enough to cause injury. It will disappear when the surface has cooled down to a safe temperature.
- The residual heat indicator can also be used as an energy saving function, for keeping food warm on a cooking zone that is still hot.

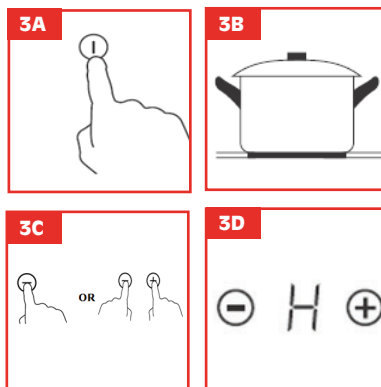

Other Features

Timer

- The cooktop timer can be set (for up to 99 minutes) in two different ways: as a minute minder or to turn one or more cooking zones off. Instructions for using the timer are provided in the full instruction manual.

Child lock

- To lock the controls to prevent unintended use, such as by children, touch the child lock control. The timer indicator will show [Lo] and all controls are disabled (except the power button).
- To unlock the controls, the cooktop must be turned on, then touch and hold the child lock control for a while.

Auto shut-down

- If a cooking zone is accidentally left on, a safety shut-down will activate after a certain period of time and switch off the cooking zone. The length of time depends on the set power level for that zone.



Hope you enjoy your new Hoover
ceramic cooktop!